

Antiqued Linen 2810

Engineered Luxury Vinyl • Grand Manor

Benefits

Family friendly (including pet)

100% Waterproof
Ultra-durable wear layer with ceramic bead technology
Easy to clean
Stain resistant, including pet stains

Safe and healthy

Antimicrobial protective treatment to inhibit the growth of mold and mildew.
Phthalates-Free products meaning that they will not affect your quality of life
FloorScore® Certified for compliance with rigorous indoor air quality requirements
E1 Certified meaning that the product meets the European standard for indoor air quality
Made of virgin PVC (no recycled content) ensuring a uniform composition that doesn't contain any harmful substances.

Performant and durable construction

Ultra-durable wear layer with ceramic bead technology
High-density rigid core vinyl planks (SPC)
Very sturdy - can withstand heavy furniture such as kitchen cabinets and islands
Performs in extreme temperatures (-4 to 122 °F / -20 to 50 °C)
Commercial abrasion resistance
BLC Certified ® - Ensures that the floor covering you're buying surpasses industry quality standards.

Easy maintenance

100% Waterproof
Antimicrobial, anti-mold and anti-fungal
Easy to clean
Stain resistant, including pet stains

Easy and versatile Installation

Floating installation
2 in 1 - comes with an attached underlayment
Can be installed in 3-season cottages (-4 to 122 °F / -20 to 50 °C)
No acclimation required
Compatible with embedded radiant heating
Can be installed on all floor levels
No telegraphing, even when installed over hard surface flooring
Installations of up to 4225 sq. ft. (65 linear ft.) in an open space without transition moldings
Matching moldings available

Quiet and comfortable

Cork backing for greater temperature and sound insulation
High soundproofing ratings (IIC/STC)

Notable look

Wide and long planks
Matte finish
Registered embossed finish and pressed bevels for the most realistic wood look.

Best-in-class Warranty

30 Days No Questions Asked Replacement

Quickship

Stock product for faster delivery

Antiqued Linen 2810

Engineered Luxury Vinyl • Grand Manor

Product Specifications

| | |
|-----------------------------|---|
| Market Segments | Residential |
| Sub Category | Light SPC |
| Collection | Grand Manor |
| Style Name | Antiqued Linen |
| Style Number | 2810 |
| Construction | Engineered Luxury Vinyl |
| Format | Plank |
| Abrasion Resistance | General Commercial Use |
| Material | Virgin PVC |
| Core Material | 70% Calcium Carbonate / 30% Virgin PVC |
| Width | 9,134" (232 mm) |
| Total Thickness | 0.315" (8 mm) |
| Wear Layer Thickness | 0.0220" (0.5500 mm) |
| Core Thickness | 0.256" (6.5 mm) |
| Backing | Cork |
| Edges | Pressed |
| Locking System | Välinge 5G |
| Backing Thickness | 0.0590" (1.5000 mm) |
| Finish | Registered Embossed |
| Top Surface | UV-Cured Polyurethane & Ceramic Bead Technology |
| Gloss | Matte |
| Pattern Repeat | 4 |
| IIC | 73 |
| STC | 72 |
| Design | Wood |
| Formaldehyde | E1 |
| Vinyl Thickness | n/a |
| Length | 72,126" (1832 mm) |
| Certifications | FloorScore, E1 Certified, Phthalates-Free, BLC Certification, Virgin PVC, Designed & stocked in Canada |
| Installation Methods | Floating, Compatible with embedded radiant heating Rigid Engineered Luxury Vinyl Installation Guide - Välinge 5G Rigid Engineered Luxury Vinyl Installation Video - Välinge 5G System |



Warranties

- [Rigid Engineered Luxury Vinyl Warranty Guide](#)
- [Rigid Engineered Luxury Vinyl Maintenance Guide](#)

Residential use

No Questions Asked
Replacement *30 days*
Stain Resistance *Lifetime*
Manufacturing Defects
Lifetime
Fade *Lifetime*
Wear *Lifetime*
Waterproof *Lifetime*
Petproof *Lifetime*

Commercial use

Stain Resistance *15 Years*
Wear *15 Years*
Manufacturing Defects *15 Years*
Fade *15 Years*
Waterproof *15 Years*
Petproof *15 Years*

Antiqued Linen 2810

Engineered Luxury Vinyl • Grand Manor

Packaging information

| | |
|---------------------------------|-------------------------------|
| Units Per Box | 5 |
| Boxes Per Pallet | 48 |
| Box Weight | 54.89 pounds (24896.76 grams) |
| Square Meters Per Box | 2.12 |
| Square Meters Per Pallet | 101.98 |
| Square Feet Per Box | 22.87 |
| Square Feet Per Pallet | 1097.76 |

Moldings

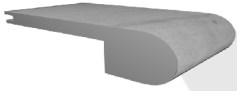

Flushmount Stair Nose - Round Reducer
Matching
94.488" X .984" X 2.834"
(2400 mm X 25 mm X 72 mm)

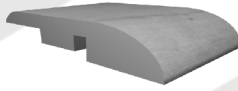

Flushmount Stair Nose - Square
Matching
94.488" X 0.375" X 1.771"
(2400 mm X 9.5 mm X 45 mm)

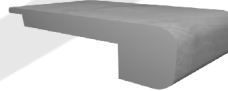

Flushmount Stair Nose - Square
Matching
94.488" X 1.378" X 4.449"
(2400 mm X 35 mm X 113 mm)

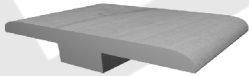

T-Molding
Matching
94.488" X 0.433" X 1.771"
(2400 mm X 11 mm X 45 mm)