



13" FLOORING SHEAR

Part# FS13 | EDI# 28847



104 S. 8th Ave. | Marshalltown, IA
Phone 800-888-0127 / 641-753-0127 | Fax 800-477-6341 / 641-753-6341
www.MARSHALLTOWN.com
WS1980revA

INTRODUCTION

Congratulations on your purchase of a MARSHALLTOWN Flooring Shear. Proudly made in the USA, MARSHALLTOWN flooring shears are heavy duty and manufactured with the highest grade materials. MARSHALLTOWN shears are designed with the flooring professional in mind to ensure accuracy and reliability.

Other features of your MARSHALLTOWN flooring shear include:

- Easy, quiet one-cut action
- Ability to cut inside and produce no dust
- Cut material up to 13" (330mm) wide and 1" (25.4mm) thick
- Built in ruler for accurate cuts
- Moveable fence for 45° (up to 8" / 203mm wide) and 90° cuts

This owner's manual provides the information needed to operate and maintain this MARSHALLTOWN flooring shear. Carefully read and follow all safety and operating instructions in this manual. Ensure every operator of this flooring shear reads this manual before operating the unit. The replacement of any part on this flooring shear by other than the manufacturer's authorized replacement part may adversely affect the performance, durability or safety of the product.

Be sure safety precautions are observed. Read and follow all safety and operating instructions in this operator's manual. The manufacturer reserves the right to make changes on or add improvements to its product at any time without prior notice or obligation. The manufacturer reserves the right to decide, upon its sole discretion and at any time, to discontinue this product.

This manual covers the MARSHALLTOWN 13" Flooring Shear. For technical questions or repair parts, please call MARSHALLTOWN customer service at 1-800-888-0127 or visit www.MARSHALLTOWN.com.

TABLE OF CONTENTS

Safety Precautions.....	3
Safety Decals	4
Warranty.....	4
Assembly	5-6
Product Operation	7
Cutting Guide	8
Parts Breakdown	8-9
Maintenance	10
Trouble Shooting.....	11

SAFETY PRECAUTIONS



- DANGER or WARNING safety signs are located near specific hazards.
- General precautions are listed on CAUTION safety signs.

- This notation appears before warnings in the text. It means that the step that follows must be carried out to avoid the possibility of personal injury or death. These warnings are intended to help the technician avoid any potential hazards encountered in the normal service procedures. We strongly recommend that the reader takes advantage of the information provided to prevent personal injury or injury to others.

THE FOLLOWING PRECAUTIONS ARE SUGGESTED TO HELP PREVENT ACCIDENTS. A CAREFUL OPERATOR IS THE BEST OPERATOR. MOST ACCIDENTS CAN BE AVOIDED BY OBSERVING CERTAIN PRECAUTIONS. READ AND TAKE THE FOLLOWING PRECAUTIONS BEFORE OPERATING THIS EQUIPMENT TO HELP PREVENT ACCIDENTS. EQUIPMENT SHOULD BE OPERATED ONLY BY THOSE WHO ARE RESPONSIBLE AND INSTRUCTED TO DO SO.



CALIFORNIA PROPOSITION 65 WARNING: This product can expose you to chemicals known to the State of California to cause cancer, birth defects, or other reproductive harm.

- Read all operating and maintenance instructions before operating or servicing the flooring shear.
- A flooring shear is only as safe as its operator. Give complete and undivided attention to the operation of the flooring shear.
- Know how to stop the flooring shear instantly.



WARNING! NEVER operate the flooring shear if any shear components have been removed.

- Keep inexperienced and unauthorized people away from the flooring shear at all times.
- Keep the flooring shear in good operational condition. Loose or damaged parts are dangerous.
- Avoid loose clothing that could get caught in moving parts.



WARNING! Keep hands and feet away from moving parts.

- Keep all warning, caution and safety instruction labels in good condition. Replace missing, damaged or illegible labels.
- Clear the work area around the shear to prevent tripping or falling onto the shear.
- Operate on level ground to prevent the flooring shear from flipping over.
- DO NOT OPERATE this flooring shear under the influence of alcohol or while taking medication that impairs your reactions.
- Use only factory authorized parts for replacement.
- Wear safety glasses when operating the flooring shear.
- Always use caution when replacing the shear blade.
- Only operate the shear with the approved materials. If extreme force is required to cut a material, it may result in personal injury and/or damage to the flooring shear.
- Wear proper protective clothing while operating flooring shear, including eye, ear, and clothing.
- Handle all solvents and cleaning agents with care and follow manufacturer's instructions on safety and disposal.

SAFETY DECALS

If your safety decals are damaged, they can be replaced by contacting Customer Service.



WS2020



WS2021

WARRANTY

This product is warranted to the original purchaser only, to be free of defects in material and workmanship under normal use, for one year from purchase date. MARSHALLTOWN shall without charge for parts and labor, repair or replace such parts which are found to be defective. All transportation charges for replacement parts must be borne by the purchaser.

For warranty service, the product must be delivered, with proof of purchase date, to MARSHALLTOWN. Contact MARSHALLTOWN Customer Service to determine the best method of delivering the product that is under warranty. The delivery of the product must be made no later than 30 days after the expiration of the warranty period.

All implied warranties, including those of merchantability and fitness for a particular purpose, are limited to one year from date of purchase by the original retail customer and to the extent permitted by law any and all implied warranties are excluded and disclaimed after the expiration of such period.

Some states do not allow limitations on how long an implied warranty lasts, or the exclusion or limitations of incidental or consequential damages, so the above limitations or exclusions may not apply to you. This warranty gives you specific legal rights, and you may also have other rights, which vary from state to state.

Exclusion from this warranty:

1. All consequential damages, including pickup and delivery of the unit, communication, mileage charges and/or rental of a replacement unit during repairs are not covered under this warranty, or are any loss of income and/or other loss resulting from the failure of the product to function due to a warranty defect.
2. This warranty will not apply when the product becomes inoperative due to misuse, normal wear, neglect, improper maintenance, accident or freight damage; has not been operated and maintained in accordance with the instructions furnished in the Operator's Manual; or has been altered or modified without approval from the factory Service Department.
3. No parts or products are to be returned to the factory without prior written approval from the factory.

ASSEMBLY

1. Lay out all of the parts.

Tools for Assembly:

- #2 Phillips Screwdriver
- #3 Phillips Screwdriver
- $\frac{3}{16}$ " Hex Wrench (included)

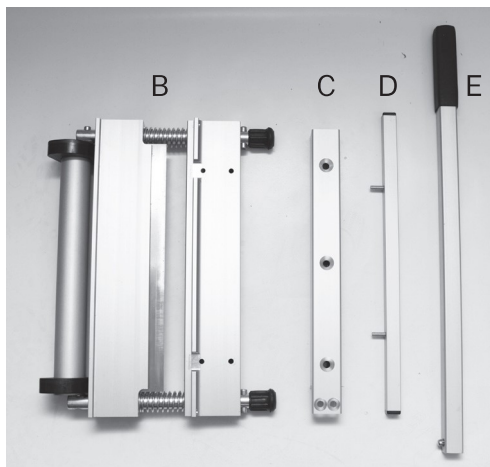
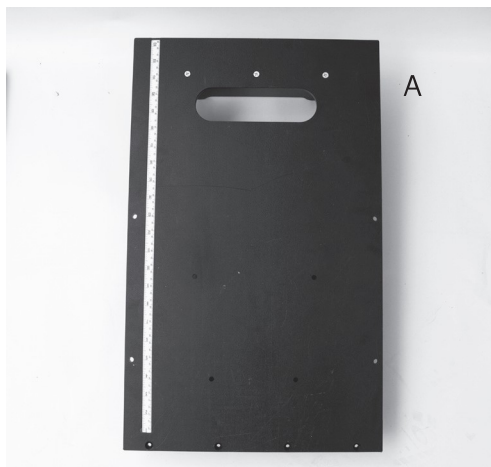

- A. Table Assembly
- B. Shear Assembly
- C. Handle Base
- D. Bed Fence
- E. Handle Extension

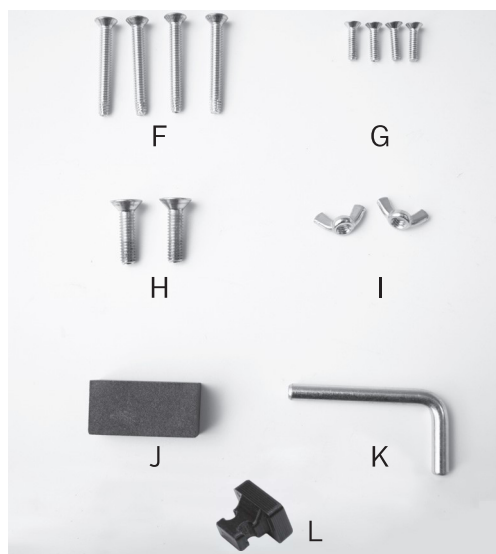

2. Lay out all hardware.

- F. #3 Phillips Flat Head Screw, $\frac{1}{4}$ "-20 X 2 $\frac{1}{2}$ " (4x)
- G. #2 Phillips Flat Head Screw, 10-24 X $\frac{3}{4}$ " (4x)
- H. $\frac{3}{16}$ " Hex Drive Flat Head Screw, $\frac{5}{16}$ "-18 X 1 $\frac{1}{4}$ " (2x)
- I. Wing Nut, $\frac{1}{4}$ "-20 (2x)
- J. Honing Stone (1x)
- K. Cam Locking Pin (1x)
- L. End Cap (1x)

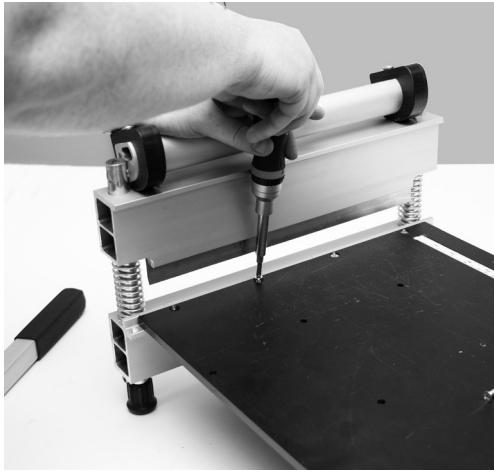

3. Attach Table Assembly (A) and Shear Assembly (B) using hardware set G.

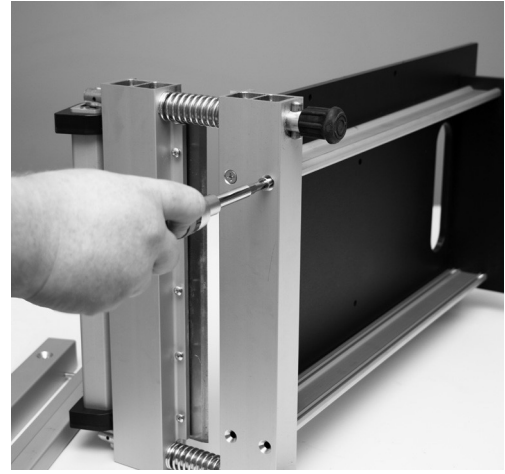

4. Attach the bed brace extrusion from the Table Assembly (A) to the Shear Assembly (B) using hardware set F.

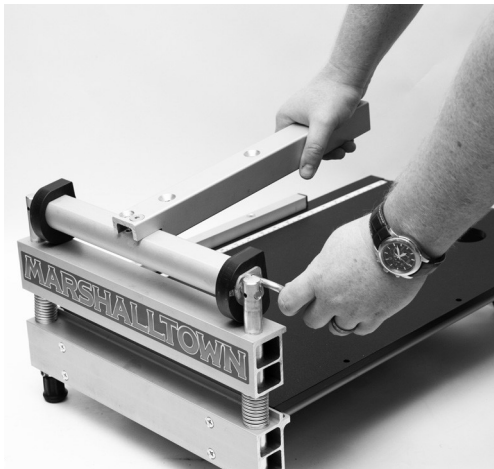

5. Attach Handle Base (C) to Shear Assembly (B) using one screw from hardware set H. Press the Handle Base (C) down and insert Cam Locking Pin (K).

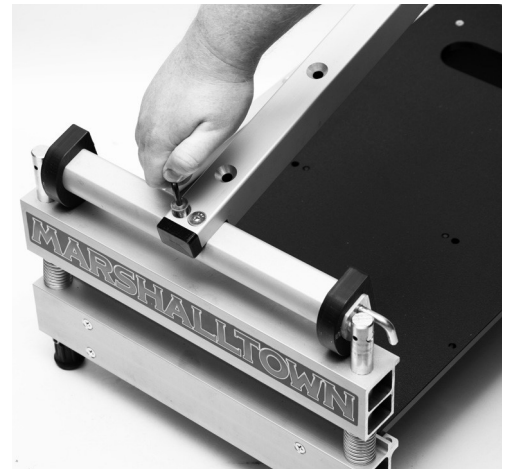

6. Remove Handle Base (C), insert End Cap (L) bevel side down into Handle Base (C) and reattach to Shear Assembly (B) using hardware set H.

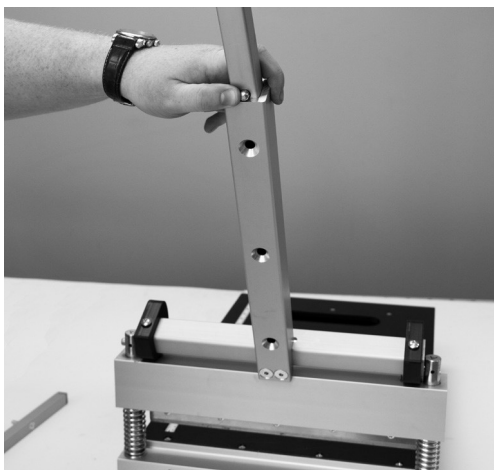

7. Press in the spring button and insert Handle Extension (E) into Handle Base (C).



8. Place the Bed Fence (D) in two holes on the right side of Table Assembly (A) and attach using hardware set I.

PRODUCT OPERATION

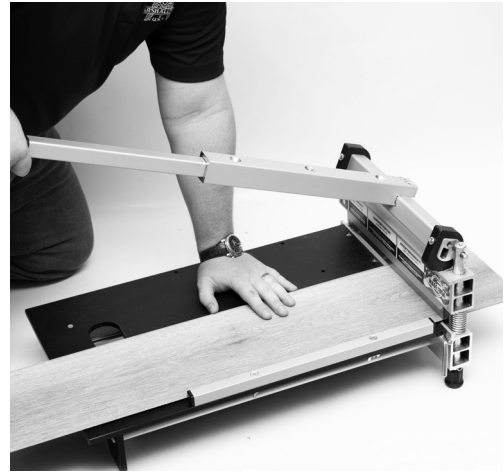
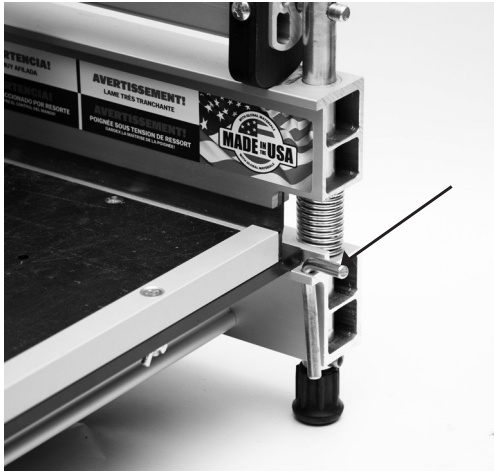

1. Press down handle and carefully remove the Cam Locking Pin. Insert Cam Locking Pin into its storage hole to prevent losing the pin. Carefully raise and release the handle.
2. Place material to be cut on the table and slide past the blade to the desired length. Press flooring against the Bed Fence and hold firmly in place to ensure a clean and accurate cut. Press handle down until the blade touches the material and then firmly press down on the handle until the material is cut.

45 DEGREE CUTS

1. Loosen wing nuts and remove the Bed Fence. Insert the fence into either of the angled holes for the desired cut and tighten wing nuts.

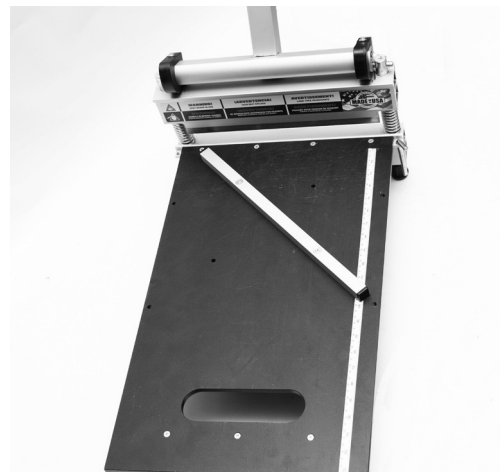
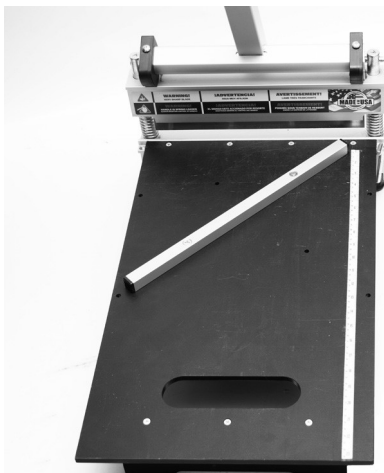

DOUBLE CUTTING

Some materials may require the double cutting method to obtain a clean cut. For these materials, make your first cut $\frac{1}{4}$ " longer than your mark. Then, make a second cut on your mark. This method will help produce cleaner cuts on some materials.

CUTTING GUIDE

The MARSHALLTOWN Flooring Shear is designed to cut a variety of materials. Some of the most common materials are laminate flooring, engineered hardwood, luxury vinyl tile, luxury vinyl plank, vinyl composite tile, fiber cement board siding, and more.

Note: DO NOT attempt to cut any solid wood, high pressure laminate, or engineered hardwood with a Janka Hardness Rating higher than 1300.

Note: Even the approved materials may vary greatly in density and hardness. If extreme force is required to cut a material stop immediately, as it could lead to damage to your shear or injury. Attempting to cut unapproved materials will void the warranty.

PARTS BREAKDOWN

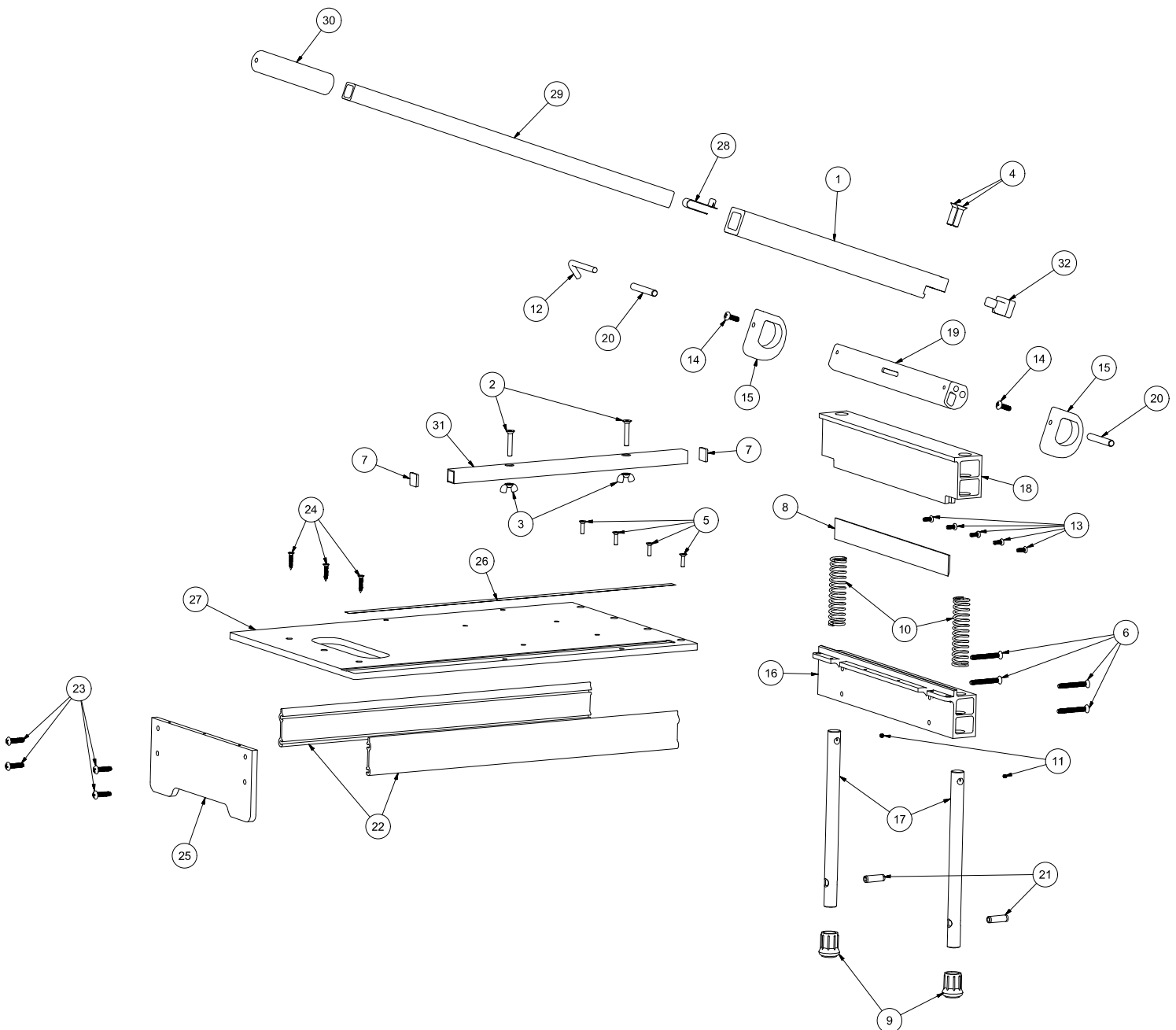

PARTS BREAKDOWN

REF #	DESCRIPTION	PART#	Quantity
1	HANDLE BASE	R4529	1
2	#3 PHILLIPS FLAT HEAD SCREW, 1/4"-20 X 1 1/2"	WR1386	2
3	WING NUT, 1/4"-20	WR1382	2
4	3/16" HEX DRIVE FLAT HEAD SCREW, 5/16"-18 X 1 1/4"	WR1383	2
5	#2 PHILLIPS FLAT HEAD SCREW, 10-24 X 3/4"	WR1384	4
6	#3 PHILLIPS FLAT HEAD SCREW, 1/4"-20 X 2 1/2"	WR1385	4
7	PLASTIC CAP	WL710	2
8	BLADE	BLADE13	1
9	SLIP-ON FOOT, 3/4"	SORF	2
10	COMPRESSION SPRING	WX2424	2
11	SET SCREW, 10-24 X 3/16"	WR1377	2
12	CAM LOCKING PIN	CAMPIN	1
13	#2 PHILLIPS PAN HEAD SCREW, 1/4"-20 X 1/2"	WR1158	5
14	#3 PHILLIPS PAN HEAD SCREW, 1/4"-20 X 3/4"	WR1378	2
15	SHEAR CAM	DCAM	2
16	ANVIL BEAM	R4525	1
17	GUIDE ROD	WU903	2
18	BLADE BEAM	R4526	1
19	CAM BAR	R4527	1
20	CAM PIN	WU905	2
21	SPRING PIN, 3/8" DIA X 1 1/4" LONG	WR1379	2
22	BED BRACE EXTRUSION	WC921	2
23	#3 PHILLIPS PAN HEAD SCREW, 1/4"-20 X 1"	WR1380	4
24	#2 PHILLIPS FLAT HEAD SCREW, #10 X 1" LONG	WR1381	3
25	LEG	R4531	1
26	ADHESIVE RULE	WX2426	1
27	BED	WL708	1
28	SPRING BUTTON	WT173	1
29	EXTENSION HANDLE	R4528	1
30	SOFT GRIP	WT507	1
31	BED FENCE	R3944	1
32	END CAP	WL741	1
33	HONING STONE (NOT SHOWN)	HONE	1
34	BED FENCE KIT - INCLUDES REF # 2,3,31 (NOT SHOWN)	FENCE	1
35	EXTENSION HANDLE - INCLUDES REF # 28,29,30 (NOT SHOWN)	EXTHANDLE	1

REPLACEMENT PARTS

REF #	DESCRIPTION	EDI	PART#
18	CAM BAR - FS13	R4527	R4527
N/A	HANDLE - FS13	R4529	R4529
N/A	EXTRUSION-BED BRACE - FS13	WC947	WC947
13	PPH MACHINE SCREW, 10-24 X 1/2" Z	WR1158	WR1158
11	SET SCREW 10-24 UNC, 0.1875" LONG	WR1377	WR1377
4	FHCS 5/16-18 X 1.25" LONG, ZINC PLATED	WR1383	WR1383
5	FHCS 10-24 UNC, 0.75" LONG	WR1384	WR1384
2	FHCS 1/4-20 UNC X 1.5" LONG	WR1386	WR1386
20	CAM PIN-FS13-ZINC PLATED	WU905	WU905

MAINTENANCE

Honing the Blade

Push the handle down until the blade 1/8" (3mm) above the tabletop. Place the provided Honing Stone (J) against the flat side of the blade. Slide the honing stone from one end of the blade to the other 3-4 times. This will remove any burrs from your blade and should be done every 100 cuts. Use caution when honing the blade. The blade is sharp and can easily cause injury. Cut resistant gloves are recommended when honing the blade.



Replacing the Blade

Use cut-resistant gloves when replacing the blade. Cover the cutting edge with a blade guard or other suitable covering. Place the shear upside down on a workbench with the jaws in the open position, creating a gap to allow blade removal. To remove the blade use a #2 Phillips screwdriver and loosen the 5 retaining screws one full turn counterclockwise. Do not remove the screws. When the last screw is loosened, the blade will slip out of the retaining slot. Cover the cutting edge of the new blade with a blade guard or other suitable covering. Slide the new blade into the slot with the beveled edge facing the screws. Center the blade in the slot and make sure the blade is fully inserted. Hand-tighten the center screw. Hand-tighten the remaining screws to complete the installation.

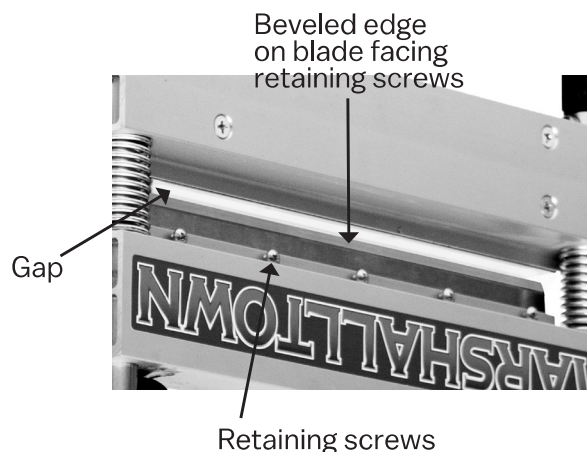

Lubrication

After every 100 cuts, it is recommended that the shear be lubricated. Use a light oil and grease (wheel bearing grease) and apply according to the image below. Lubricating the shear will extend the life of the shear and result in easier cutting.

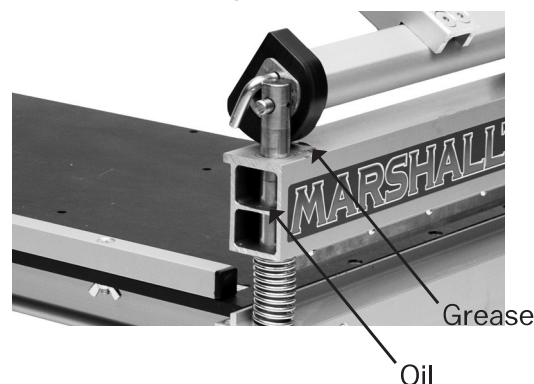

TROUBLESHOOTING

ISSUE	RESOLUTION
Shear won't cut desired material	Review cutting guide in manual to confirm it is a confirmed material. Contact MARSHALLTOWN customer service. Do not attempt to use extreme force to cut the material.
Shear is leaving a jagged edge on flooring	Use honing stone to carefully touch up the blade as described in the manual. Use double cutting method as described in the manual if necessary.
Shear requires more force to cut than normal	Use honing stone to carefully touch up the blade as described in the manual. Follow the maintenance section of the manual to oil and grease the shear.



104 S. 8th Ave., Marshalltown, IA
Phone 800-888-0127 / 641-753-0127
Fax 800-477-6341 / 641-753-6341
www.MARSHALLTOWN.com
WS1980revA