



KERDI-DRAIN Shower Checklist

Project reference: _____

FOOTPRINT & BASE

Measurement of Shower

Length: _____ Width: _____ Drain placement: Center Other

1 Pre-sloped KERDI Shower Tray or

Mortar Bed

Note: Trays can be modified by cutting or extending with dry-pack mortar.

Note: Be sure to order enough KERDI membrane to cover the surface of the mortar bed.

- 32" x 38" (KST965/810BF)
- 36" x 48" (KST915/1220BF)
- 48" x 60" (KST1220/1525)
- 36" x 36" (KST915BF)
- 48" x 48" (KST1220BF)
- 48" x 72" (KST1220/1830)
- 38" x 38" (KST965BF)
- 38" x 60" (KST965/1525)
- 60" x 60" (KST1525)
- 38" x 38" Neo-angle (KST965NA/BF)
- 38" x 60" Off-center (KST965/1525S)
- 72" x 72" (KST1830)

2 KERDI-BOARD Curb and/or

KERDI Shower Ramp

- 38" L x 4-1/2" W x 6" H (KBSC115150970)
Qty: _____
- 48" L x 4-1/2" W x 6" H (KBSC1151501220)
Qty: _____
- 60" L x 4-1/2" W x 6" H (KBSC1151501524)
Qty: _____

- 48" L x 12" W x 1-1/4" H (KSR 305/1220)
Qty: _____

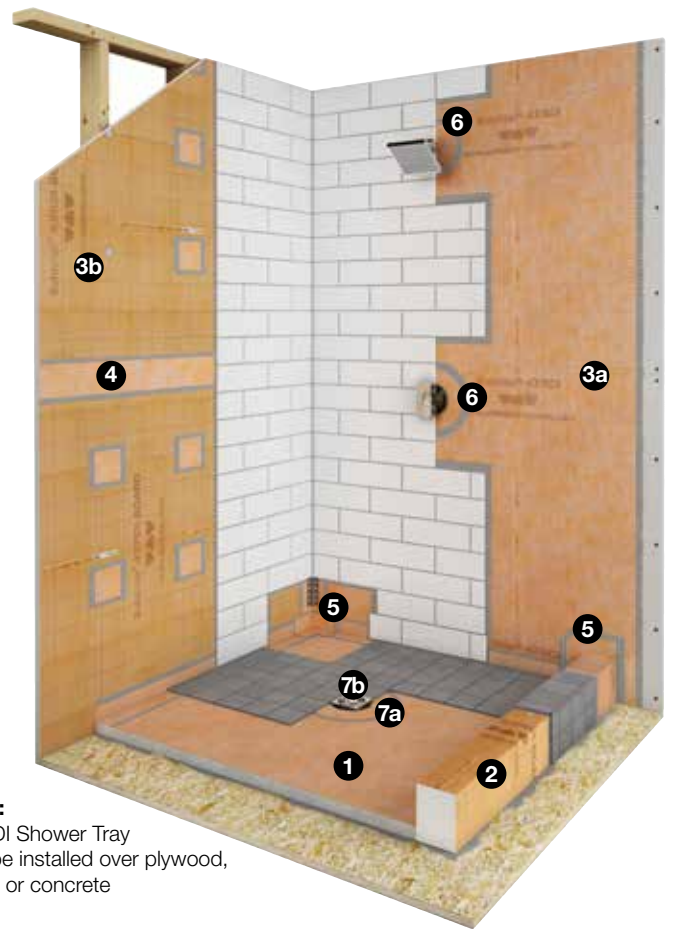

Note: KERDI Shower Tray can be installed over plywood, OSB, or concrete

WALLS

Measurement of Walls

Wall #1: _____ x _____ = _____ Wall #2: _____ x _____ = _____
 Wall #3: _____ x _____ = _____ Wall #4: _____ x _____ = _____
 Wall #5: _____ x _____ = _____ Total ft² = _____

3 Type of Wall and Waterproofing

3a. Solid backing with KERDI or

- Dry wall
- Concrete board

KERDI membrane

- 3'-3" x 16'-5" (54 ft²) (KERDI200/5M)
- 3'-3" x 23' (75 ft²) (KERDI200/7M)
- 3'-3" x 33' (108 ft²) (KERDI200/10M)
- 3'-3" x 65'-7" (215 ft²) (KERDI200/20M)
- 3'-3" x 98'-5" (323 ft²) (KERDI200)
- 6'-7" x 98'-5" (646 ft²) (KERDI200200)
- 6'-7" x 49'-2.5" (323 ft²) (KERDI200200/15M)

3b. Waterproof building panel

KERDI-BOARD

- 32" x 48" x 1/2" (KB121220812)
- 64" x 48" x 1/2" (KB1212201625)
- 96" x 48" x 1/2" (KB1212202440)

KERDI-BOARD-ZT/-ZS

- Washers
- Screws

4 KERDI-BAND

(5" wide - used to connect KERDI membrane or KERDI-BOARD with 2" overlap)

Linear feet wall seams: _____ Linear feet pan seams: _____

- 5" x 16'-5" (KEBA100/125/5M)
- 5" x 33' (KEBA100/125/10M)
- 5" x 98'-5" (KEBA100/125)

5 KERDI-KERECK (waterproof corners)

Note: Drain Kit includes 4 inside and 2 outside corners

- Inside corners: _____ (KERECK/FI2 - 2 pack or KERECK/FI10 - 10 pack)
- Outside corners: _____ (KERECK/FA2 - 2 pack or KERECK/FA10 - 10 pack)

6 KERDI-SEAL (waterproof seals)

Note: Drain Kit includes 1 pipe seal with 3/4" opening and 1 mixing valve seal

- Pipe seal: _____ (KMS185/12 - 1/2" opening or KMS185/20 - 3/4" opening)
- Mixing valve seal: _____ (KMSM235/114 - 4-1/2" opening)

OPTIONAL: KERDI-FIX (sealing and bonding compound)

- 290 ml KERDIFIX/BW (Bright white)
- 290 ml KERDIFIX/G (Grey)
- 100 ml KERDIFIX/100G (Grey)

View installation videos at: www.schluter.com

IMPORTANT: Please read the Schluter®-Shower System Installation Handbook and Schluter®-Shower System Technical Data Sheet to ensure the materials you have selected are appropriate for your application.

DRAIN

7a Flange Selection

- ABS 2" (KD2FLKABS)
- PVC 2" (KD2FLKPVC)
- ABS 3" (KD3FLKABS)
- PVC 3" (KD3FLKPVC)
- ABS 2" Horizontal (KDH2FLKABS)
- PVC 2" Horizontal (KDH2FLKPVC)
- Stainless Steel 2" (KD2FLKE)
- Stainless Steel 3" (KD3FLKE)

Adaptor Kits

Convert an existing clamping ring drain

- 5-1/4" Adaptor Kit (KDA5FLKABS)
- 7-1/2" Adaptor Kit (KDA7FLKABS)

7b Grate Selection

		4" GRATES				
		Stainless Steel CLASSIC	Brushed Anodized Aluminum CONTOUR	Brushed Stainless Steel CURVE	Brushed Stainless Steel FLORAL	Brushed Stainless Steel PURE
STYLE	FINISH					
Stainless Steel		<input type="checkbox"/> KD4GRKE		<input type="checkbox"/> KDIF4GRKEBD6	<input type="checkbox"/> KDIF4GRKEBD5	<input type="checkbox"/> KDIF4GRKEBD8
Chrome		<input type="checkbox"/> KD4GRKEP				
Oil-rubbed Bronze		<input type="checkbox"/> KD4GRKEOB				
Nickel		<input type="checkbox"/> KD4GRKET	<input type="checkbox"/> KD4GRKATGB	<input type="checkbox"/> KDIF4GRKEBTD6	<input type="checkbox"/> KDIF4GRKEBTD5	<input type="checkbox"/> KDIF4GRKEBTD8
Rose Gold		<input type="checkbox"/> KD4GRKERG		<input type="checkbox"/> KDIF4GRKEBRGD6	<input type="checkbox"/> KDIF4GRKEBRGD5	<input type="checkbox"/> KDIF4GRKEBRGD8
Vintage Gold		<input type="checkbox"/> KD4GRKEVG		<input type="checkbox"/> KDIF4GRKEBVG6	<input type="checkbox"/> KDIF4GRKEBVG5	<input type="checkbox"/> KDIF4GRKEBVG8
Classic Gold		<input type="checkbox"/> KD4GRKECG		<input type="checkbox"/> KDIF4GRKEBCGD6	<input type="checkbox"/> KDIF4GRKEBCGD5	<input type="checkbox"/> KDIF4GRKEBCGD8
Copper			<input type="checkbox"/> KD4GRKAKGB			
Brass			<input type="checkbox"/> KD4GRKAMGB			
Cream				<input type="checkbox"/> KDIF4GRKTSKD6	<input type="checkbox"/> KDIF4GRKTSKD5	<input type="checkbox"/> KDIF4GRKTSKD8
Greige				<input type="checkbox"/> KDIF4GRKTSBGD6	<input type="checkbox"/> KDIF4GRKTSBGD5	<input type="checkbox"/> KDIF4GRKTSBGD8
Stone Grey				<input type="checkbox"/> KDIF4GRKTSBGD6	<input type="checkbox"/> KDIF4GRKTSBGD5	<input type="checkbox"/> KDIF4GRKTSBGD8
Bronze				<input type="checkbox"/> KDIF4GRKTSOBD6	<input type="checkbox"/> KDIF4GRKTSOBD5	<input type="checkbox"/> KDIF4GRKTSOBD8
Matte Black				<input type="checkbox"/> KDIF4GRKMGSD6	<input type="checkbox"/> KDIF4GRKMGSD5	<input type="checkbox"/> KDIF4GRKMGSD8
Matte White				<input type="checkbox"/> KDIF4GRKMBWD6	<input type="checkbox"/> KDIF4GRKMBWD5	<input type="checkbox"/> KDIF4GRKMBWD8

TRENDLINE

or **TILE 4"** KD4GRKECS

6" GRATES

Stainless Steel	<input type="checkbox"/> KD6GRKE		<input type="checkbox"/> KD6GRKRE	
-----------------	----------------------------------	--	-----------------------------------	--

ACCESSORIES

Benches and niches can be selected on the other side of this page.



Schluter® Thin-set Mortar



*Applicable when used as a Thin-Set System. For full warranty details, please visit www.schluter.com/warranty



KERDI-LINE Shower Checklist

Project reference: _____

FOOTPRINT & BASE

Measurement of Shower

Length: _____ Width: _____ Drain placement: Center Other

1 Pre-sloped KERDI Shower Tray

or

Mortar Bed

Note: Trays can be modified by cutting or extending with dry-pack mortar.

- | | | |
|-----------------------------------------------------------------|-----------------------------------------------------------------|-----------------------------------------------------------------|
| <input type="checkbox"/> 39" x 39"
(KSLT1000) | <input type="checkbox"/> 39" x 39" Perimeter
(KSLT1000S) | <input type="checkbox"/> 38" x 76" Perimeter
(KSLT965/1930S) |
| <input type="checkbox"/> 48" x 48"
(KSLT1220) | <input type="checkbox"/> 48" x 48" Perimeter
(KSLT1220S) | <input type="checkbox"/> 76" x 38" Perimeter
(KSLT1930/965S) |
| <input type="checkbox"/> 55" x 55"
(KSLT1395) | <input type="checkbox"/> 55" x 55" Perimeter
(KSLT1395S) | |
| <input type="checkbox"/> 36" x 55" Perimeter
(KSLT915/1395S) | <input type="checkbox"/> 36" x 72" Perimeter
(KSLT915/1830S) | |

Note: Be sure to order enough KERDI membrane to cover the surface of the mortar bed.

2 KERDI-BOARD Curb

and/or

KERDI Shower Ramp

- | | |
|------------------------------------------------------------------------------------|-----------------------------------------------------------------------------------|
| <input type="checkbox"/> 38" L x 4-1/2" W x 6" H
(KBSC115150970)
Qty: _____ | <input type="checkbox"/> 48" L x 12" W x 1-1/4" H
(KSR 305/1220)
Qty: _____ |
| <input type="checkbox"/> 48" L x 4-1/2" W x 6" H
(KBSC1151501220)
Qty: _____ | |
| <input type="checkbox"/> 60" L x 4-1/2" W x 6" H
(KBSC1151501524)
Qty: _____ | |



WALLS

Measurement of Walls

Wall #1: ____ x ____ = ____ Wall #2: ____ x ____ = ____
 Wall #3: ____ x ____ = ____ Wall #4: ____ x ____ = ____
 Wall #5: ____ x ____ = ____ Total ft² = _____

3 Type of Wall and Waterproofing

3a. Solid backing with KERDI

or

3b. Waterproof building panel

- Dry wall
 Concrete board

KERDI membrane

- 3'-3" x 16'-5" (54 ft²)
(KERDI200/5M)
 3'-3" x 23' (75 ft²)
(KERDI200/7M)
 3'-3" x 33' (108 ft²)
(KERDI200/10M)
 3'-3" x 65'-7" (215 ft²)
(KERDI200/20M)
 3'-3" x 98'-5" (323 ft²)
(KERDI200)
 6'-7" x 98'-5" (646 ft²)
(KERDI200200)
 6'-7" x 49'-2.5" (323 ft²)
(KERDI200200/15M)

KERDI-BOARD

- 32" x 48" x 1/2"
(KB121220812)
 64" x 48" x 1/2"
(KB1212201625)
 96" x 48" x 1/2"
(KB1212202440)

KERDI-BOARD-ZT/-ZS

- Washers
 Screws

4 KERDI-BAND

(5" wide - used to connect KERDI membrane or KERDI-BOARD with 2" overlap)

Linear feet wall seams: _____ Linear feet pan seams: _____

- 5" x 16'-5" (KEBA100/125/5M) 5" x 33' (KEBA100/125/10M) 5" x 98'-5" (KEBA100/125)

5 KERDI-KERECK (waterproof corners)

Note: Drain Kit includes 4 inside and 2 outside corners

- Inside corners: _____
(KERECK/FI2 - 2 pack or KERECK/FI10 - 10 pack)
 Outside corners: _____
(KERECK/FA2 - 2 pack or KERECK/FA10 - 10 pack)

6 KERDI-SEAL (waterproof seals)

Note: Drain Kit includes 1 pipe seal with 3/4" opening and 1 mixing valve seal

- Pipe seal: _____
(KMS185/12 - 1/2" opening or KMS185/20 - 3/4" opening)
 Mixing valve seal: _____
(KMSMV235/114 - 4-1/2" opening)

OPTIONAL: KERDI-FIX (sealing and bonding compound)

- 290 ml KERDIFIX/BW (Bright white)
 290 ml KERDIFIX/G (Grey)
 100 ml KERDIFIX/100G (Grey)

View installation videos at: www.schluter.com

IMPORTANT: Please read the Schluter®-Shower System Installation Handbook and Schluter®-Shower System Technical Data Sheet to ensure the materials you have selected are appropriate for your application.



Note: KERDI Shower Tray can be installed over plywood, OSB, or concrete

DRAIN

7a Channel Body Selection

- Center outlet

Length: _____

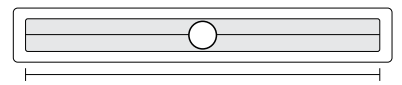

Note: The stated length of the KERDI-LINE is the size of the grate assembly, the actual opening must be 1" larger all around to accommodate the channel body flange.

- | | | |
|---------------------------------------------------|---------------------------------------------------|----------------------------------------------------|
| <input type="checkbox"/> 19-11/16"
(KL1V60E50) | <input type="checkbox"/> 39-3/8"
(KL1V60E100) | <input type="checkbox"/> 59-1/16"
(KL1V60E150) |
| <input type="checkbox"/> 23-5/8"
(KL1V60E60) | <input type="checkbox"/> 43-5/16"
(KL1V60E110) | <input type="checkbox"/> 62-15/16"
(KL1V60E160) |
| <input type="checkbox"/> 27-9/16"
(KL1V60E70) | <input type="checkbox"/> 47-1/4"
(KL1V60E120) | <input type="checkbox"/> 66-7/8"
(KL1V60E170) |
| <input type="checkbox"/> 31-1/2"
(KL1V60E80) | <input type="checkbox"/> 51-3/16"
(KL1V60E130) | <input type="checkbox"/> 70-13/16"
(KL1V60E180) |
| <input type="checkbox"/> 35-7/16"
(KL1V60E90) | <input type="checkbox"/> 55-1/8"
(KL1V60E140) | |

- Off-set outlet

Length: _____

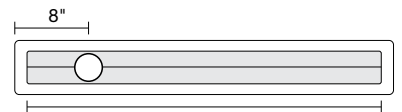

Note: The stated length of the KERDI-LINE is the size of the grate assembly, the actual opening must be 1" larger all around to accommodate the channel body flange.

- | | | |
|---------------------------------------------------|---------------------------------------------------|----------------------------------------------------|
| <input type="checkbox"/> 27-9/16"
(KL1VO60E70) | <input type="checkbox"/> 35-7/16"
(KL1VO60E90) | <input type="checkbox"/> 43-5/16"
(KL1VO60E110) |
| <input type="checkbox"/> 31-1/2"
(KL1VO60E80) | <input type="checkbox"/> 39-3/8"
(KL1VO60E100) | <input type="checkbox"/> 47-1/4"
(KL1VO60E120) |

7b Grate Selection

STYLE - Brushed stainless steel



- CURVE
SOLID

- FLORAL

- PURE



- Brushed Stainless steel (EB)



- Chrome (EP)

SQUARE



- Brushed Stainless steel (EB)



- Chrome (EP)

TILE



- Tileable covering support (ECS)

If you have selected a SOLID or SQUARE grate you must choose your frame height:



- 3/4" frame height
for tile thicknesses of 1/8" - 9/16"



- 1-1/8" frame height
for tile thicknesses of 1/2" - 1"

ACCESSORIES

KERDI-BOARD Benches

Note: Waterproofing corners are included

Triangle:

- 16" L x 16" W x 20" H (KBSB410TA) 24" L x 24" W x 20" H (KBSB610TA)

Rectangle:

- 11-1/2" L x 38" W x 20" H (KBSB290970RA) 16" L x 48" W x 20" H (KBSB4101220RA)

KERDI-BOARD to Make a Custom Bench

- 96" x 24-1/2" x 2" (KB506252440)

KERDI-BOARD Niches

- 12" W x 6" H (KB12SN305152A)
 12" W x 12" H (KB12SN305305A)
 12" W x 20" H - with shelf (KB12SN305508A1)
 12" W x 28" H - with shelf (KB12SN305711A1)

KERECK Bench/Neo-angle Corner Kit

- 1 right and 1 left bench corner, and two 135° inside corners (KERSB135K)