

Luxury Vinyl Installation Guide – 5G Locking System Dynamix – XL Chevron

Expansion:

All floors naturally expand and contract and therefore require expansion space around perimeter walls and any vertical obstructions. The expansion space should be equal to the thickness of the material being used or a minimum of 1/4".

Tools Required:

Marker/Pen, Tape measure, Chalk Line, Square, 6ft Level or straight edge, White Mallet, Hammer, Tapping Block, Last Board Puller, Miter Saw, Jamb saw, Table saw, Jig Saw, circular saw, shims for expansion spacers.

Note: If underlay is attached, the only approved additional underlay that can be used is FuzSonic Universal or FuzSonic Universal MB, or Dura Son MB which are ultra-high density and thin. Do not use additional layers of unapproved underlay as this will cause joints to flex and eventually break.

A 6 mil. poly moisture barrier is required to minimize any potential MVER or moisture issues.

Job Preparation:

- Calculate the surface area required and add 5-10% and then round up to the nearest full carton.
- Acclimatize flooring for temperature by spreading out sealed packages in room/environment where the floor will be installed at a room temperature between 16°C (60°F) and 27°C (80°F) for 48 hours. Ensure packages remain sealed/closed during acclimation and until ready to install.
- **WARNING: DO NOT INSTALL THIS FLOOR WHERE IT WILL BE EXPOSED TO TEMPERATURES GREATER THAN 70°C and/or directly under the sunlight, please contact your supplier to confirm suitability of this product.**
- Will perform in extreme temperature conditions: -30°C – 70°C (-22°F – 158°F)
- Ensure subfloor is clean, flat, dry and sound and free of any debris that might impact installation. The subfloor must be Level/Flat to 3/16" per 10-foot radius
- If height differences do exist, peaks will need to be ground down and valleys will need to be filled with patching compound.
- Remove any existing quarter round and undercut door jambs allowing the flooring to float under the jamb to provide a preferred aesthetic.
- This flooring replicates the look of a natural product which has natural variations in color, texture, and sheen/gloss. For best visual effect, shuffle planks or tiles from several cartons and do not install similar planks or tiles next to one another.
- Check flooring planks for any visual defects in structure or aesthetics. Planks installed with visual defects are not covered under warranty.

Note: The installer is the final inspector of product and responsible for subfloor and overall job site conditions ensuring compliance with referenced standards in support of any associated warranty conditions. If the product or job site does not meet the referenced conditions, do not proceed with installation until conditions are corrected. Please read through installation instructions thoroughly before commencing with installation.

Subfloor Requirements:

Wood subfloors must be 3/4" thick, dry and well secured with moisture content < 12%. If installing over a crawl space install 6 mil. poly over the dirt in the crawl space. Ensure the crawl space is adequately ventilated. Wood subfloors must be nailed down or screwed down every 6" along the joist to avoid squeaking.

Concrete subfloors must be fully cured for at least 60 days. The subfloor must remain dry all year round. Test for moisture using a calcium chloride test.

Installation Instructions:

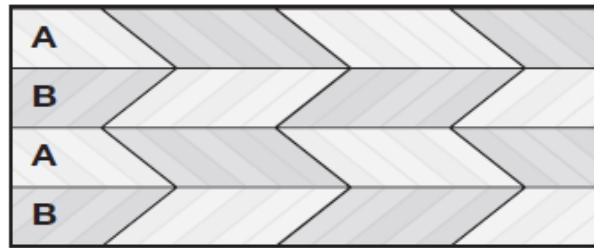

SET SPACERS

1. Set spacers around the perimeter of the subfloor allowing a 1/4" gap. (This gives room for movement or expansion of the flooring). Spacers should remain until installation is complete.
2. Installation should start in a left-hand corner with the tongue facing the wall.

BALANCE THE LAYOUT OF THE ROOM

3. Determine the direction the chevron planks will be installed lengthwise. Divide the width of the room by the width of one plank (12"). The result is the number of rows of planks you will have. If one row is less than one full plank, you will split the difference and trim the first and last rows. This will center/balance the chevron pattern.

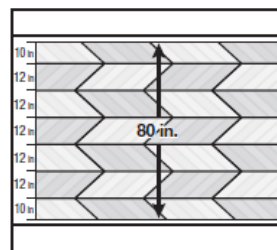
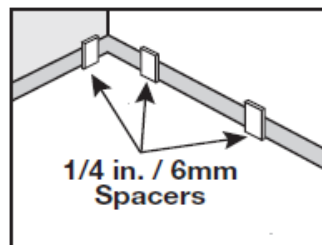

PREPARING AND INSTALLING YOUR FLOOR

4. Separate the two different types of planks, **A** & **B** are printed on the groove edge.

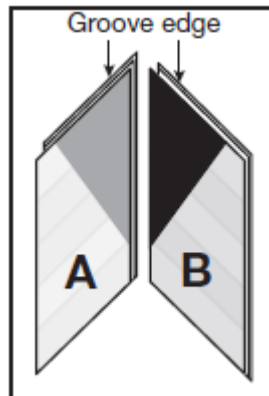

5. Take a full **A** and **B** plank and remove the 45° angle from the tongue edge of both planks.
Note: If the two starting walls are not perfectly square, you may need to remove more from the starting planks.
6. Starting in the left corner of the room, place the **A** plank with long tongue edge against the spacers along the starting wall. Interlock planks **A** and **B** by interlocking the tongue of **B** with the groove of **A**.
Note: After joining the planks, ensure the planks are properly aligned. The points of the planks should create a 90° angle. You can use a 90° square to check the angle/alignment.
7. Once the planks are properly placed, tap the joint with a soft-faced hammer and, using a tapping block, tap along the straight edge to close any gaps.

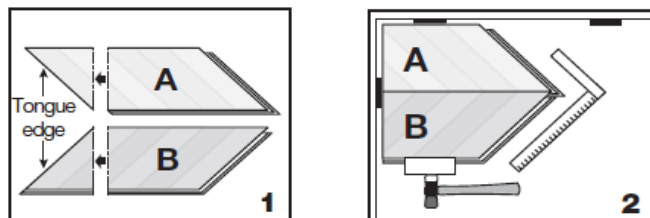

8. Continue the installation repeating the steps of squaring and closing joints until all full-size planks are installed in the first two rows.
Note: All of the first row (along the wall) will be **A** planks, the second row will be **B** planks.
9. It is key that they points are precisely aligned (forming 90° angles) throughout the installation.
10. Once all full-length planks have been installed in the first two rows, cut the last two planks to fit, maintaining the expansion gap created by the spacers.
Note: If you have a small triangular shaped piece, less than 6", we recommend you apply a small amount of "instant glue" in the groove edge of the plank.

11. Repeat the above steps until you reach the last row.

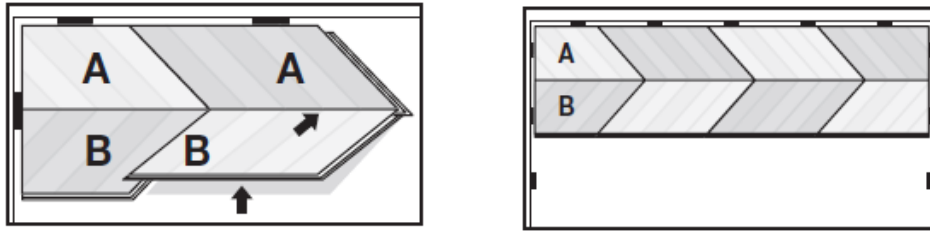

12. To install the final row, trim the planks to the appropriate width, if needed. Start placing the planks along the wall and use a pull par to lock the edges together. (Continue to only use the soft-faced hammer on the short edges).

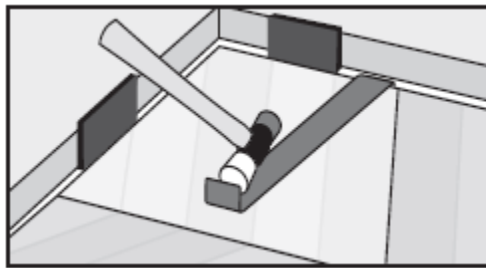

HELPFUL TIPS

Fitting around irregularly shaped objects.

- Make a template to fit around pipes, vents, or irregular shaped objects. Place the template on top of the plank and trace using a utility knife or jigsaw. Install plank as normal.
- Be sure to leave a minimum of ¼" expansion space around all fixed objects.
- Mix planks from different boxes to increase the randomization
- throughout the room.

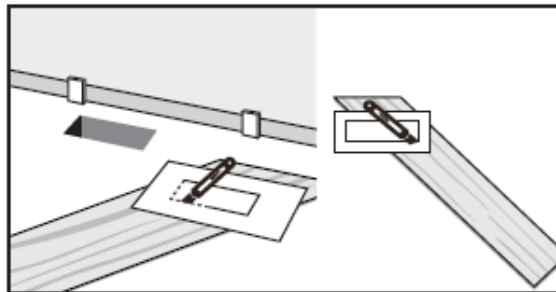

In-floor Radiant Heat:

This floor can be installed over radiant heat using the floating method.

- Turn the heat off for 24 hours before, during and 24 hours after installation when installing over radiant heated subfloors, floor temperature must not exceed 85°F (30°C).

Warning: Electric heating mats that are not embedded into the subfloor are not recommended for use underneath this floor. Using electric heating mats that are not embedded and applied directly underneath this floor could void the warranty for your floor in case of failure. It is best to install flooring over embedded hydronic radiant floor heating systems only and adhere to the guidelines listed above.

After Installation:

Flooring should be one of the last items installed in a project. In order to protect the floors while other trades are finishing their work prior to final cleanup, use rosin paper and only use 3M ScotchBlue™ 2080 Tape to hold the rosin paper to the floor (other blue tapes may damage the finish). Clean the floor thoroughly before laying the rosin paper to ensure that no debris is trapped underneath.

- Dust-mop or vacuum your floor to remove any dirt or debris.
- It is suggested that you clean the floor using a recommended vinyl cleaner.
- Install any transition pieces that may be needed (reducers, T-moldings, etc.).

Protection and Maintenance of Your Floor:

Lasting beauty can be achieved through purchasing a quality floor cleaner (FuzClean vinyl cleaner or equivalent) and providing proper on-going maintenance.

- Furniture should be moved onto the newly installed floor using an appliance hand truck over hardboard runways.
- Oil or petroleum-based products can result in surface staining. Do not track asphalt-driveway sealer or automobile oil drips onto the floor covering.
- Caster wheeled chairs should have wide, rubber casters. Protective mats are required under office chairs.
- Use non-staining mats. Rubber may discolor the floor.
- Use walk-off mats at entrances to prevent dirt and grit from being tracked on to the floor.
- Sweep or vacuum the floor regularly to remove loose dirt. DO NOT use vacuums that use a beater bar or turn beater bar off.
- **DO NOT USE:**
 - Electric brooms with hard plastic bottoms with no padding.
 - Harsh cleaners or chemicals on the floor.
 - Abrasive scrubbing tools.
 - Detergents, abrasive cleaners, vinegar or “mop and shine” products.
 - Steam mops.

Note: A floating floor must be allowed to float and therefore moldings and/or cabinets must be affixed to the walls or subfloor directly allowing the floor to float. Furniture and appliances should < 230kg (500lbs) per item. The total weight on the floor should not exceed 19kg/40lbs per square foot. If required, Cork backed planks can be glued down with the use of an approved Vinyl flooring adhesive (Fuzbond 4200 or equivalent).