

BLADE CHANGE INSTRUCTIONS

For all ratchet-wheel style knives including

Models: CL-1, H-1, L-1, L-2, L-5, MXP-L, NH-1, NOL-1, OL, XH-1, XL-2, 300

1

TURN RATCHET-WHEEL
DIAL COUNTER-
CLOCKWISE TO LOOSEN
LOCKING MECHANISM.

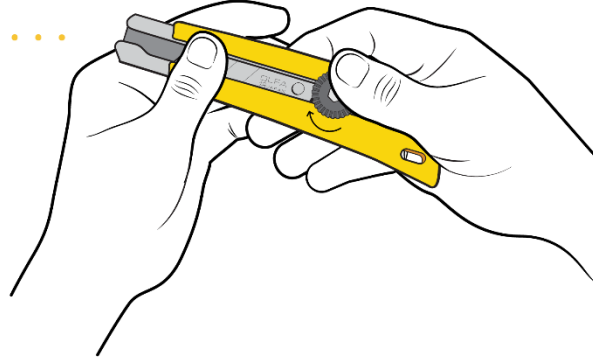

2

SLIDE RATCHET-WHEEL
ASSEMBLY PAST BASE OF
HANDLE TO REMOVE.

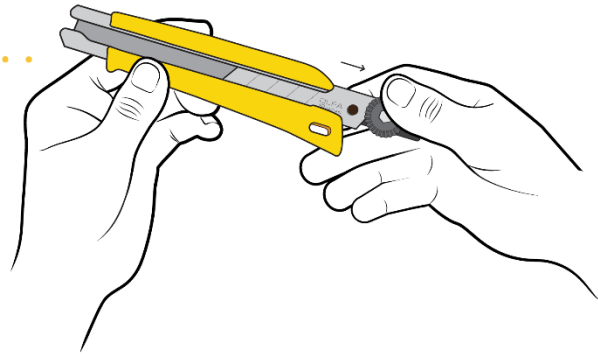

BLADE CHANGE INSTRUCTIONS

For all ratchet-wheel style knives including

Models: CL-1, H-1, L-1, L-2, L-5, MXP-L, NH-1, NOL-1, OL, XH-1, XL-2, 300

3

REMOVE RATCHET-WHEEL
DIAL FROM BLADE.
CAREFULLY SLIDE USED
BLADE SECTION OUT OF
HANDLE AND DISPOSE OF
PROPERLY IN SHARPS
CONTAINER.

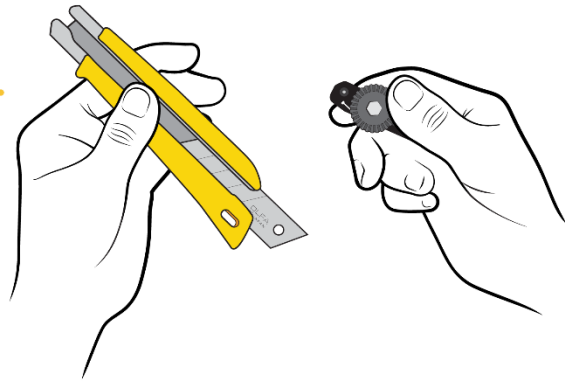

4

INSERT NEW BLADE
INTO CHANNEL. ALIGN
WITH ASSEMBLY BY
PLACING THE HOLE IN
THE BLADE OVER THE
RAISED MOUNTING
POINT.

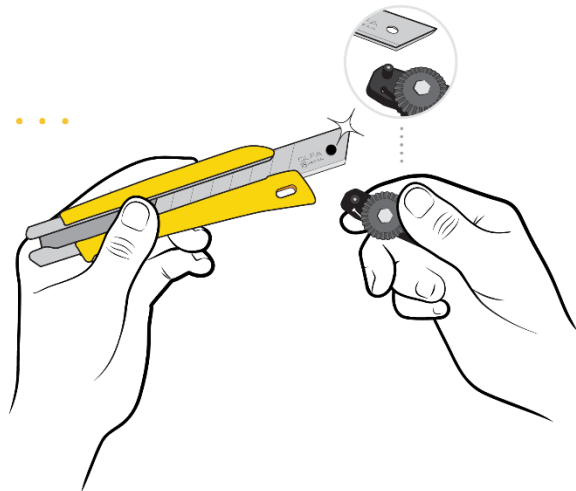

BLADE CHANGE INSTRUCTIONS

For all ratchet-wheel style knives including

Models: CL-1, H-1, L-1, L-2, L-5, MXP-L, NH-1, NOL-1, OL, XH-1, XL-2, 300

5

SLIDE RATCHET-WHEEL
ASSEMBLY AND BLADE
FORWARD.

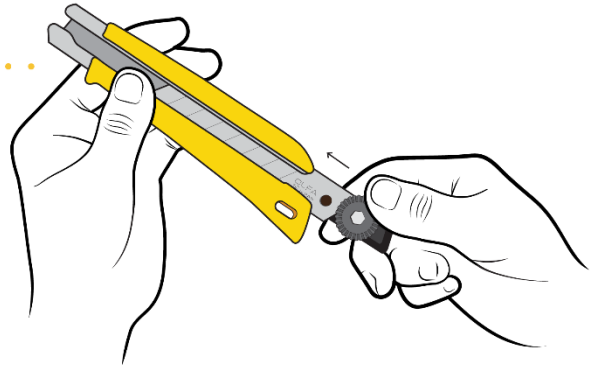

6

TURN RATCHET-WHEEL DIAL
CLOCKWISE TO TIGHTEN THE
LOCKING MECHANISM AND
RETURN TO WORK.

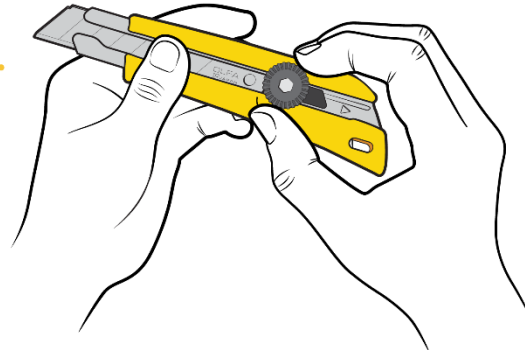



BLADE CHANGE INSTRUCTIONS

For all ratchet-wheel style knives including
Models: CL-1, H-1, L-1, L-2, L-5, MXP-L, NH-1, NOL-1, OL, XH-1, XL-2, 300

Videos:



How to SNAP a blade:

