

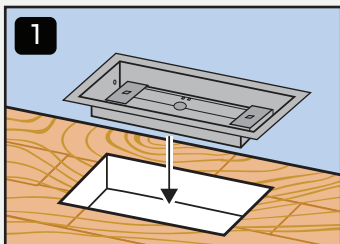

Framed Floor Vent INSTALL GUIDE

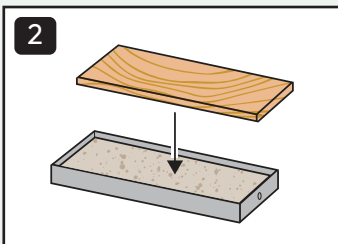

Dry fit **body** in opening.



Apply adhesive bonding material in **tray**. Insert flooring material.

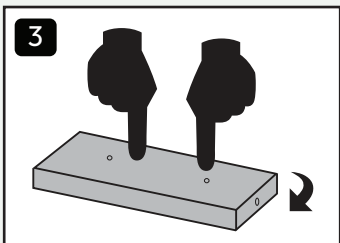

Flip **tray** upside down. Apply even pressure until flooring material lies flat with rim of **tray**.

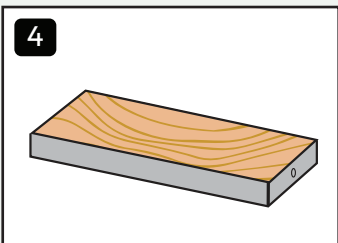

Wait to cure.

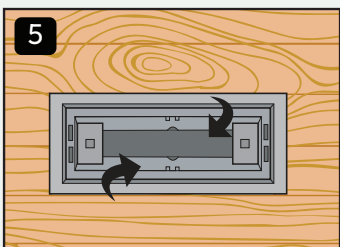

To adjust airflow, remove **tray** and bend dampers. For optimal air flow, push dampers past 90°.

For **Lite** versions of this product, dampers are not included. Optional dampers are sold separately.

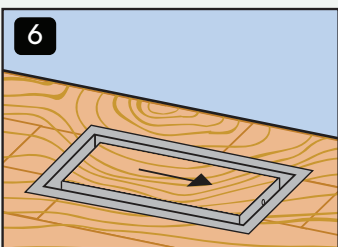

Insert **tray** in place. That's it! Fittes to perfection.

Fittes

Framed Floor Vent [Luxe+] INSTALL GUIDE

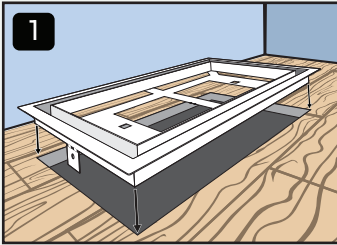

Dry fit **body** in opening.

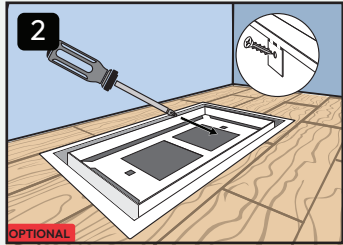

Secure with screws.

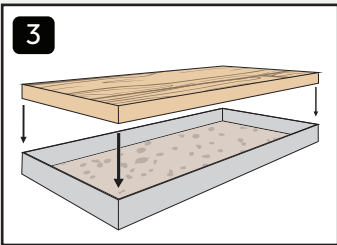

Apply adhesive bonding material in **tray**. Insert flooring material.

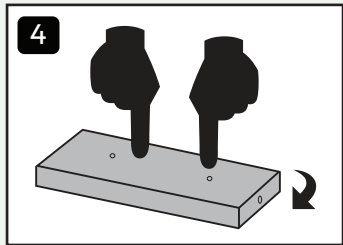

Flip **tray** upside down. Apply even pressure until flooring material lies flat with rim of **tray**.

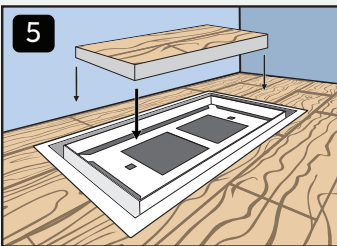

Insert **tray** into the body.

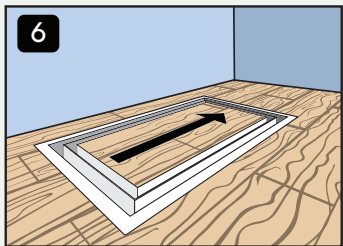

Slide in place. That's it! Fittes to perfection.