



# Floor & Wall Rollers



**Lightweight 35 lb. Roller**  
10-935

**100 lb. Linoleum Roller**  
10-952

**75 lb. Linoleum Roller**  
10-950

Removable handle for  
convenient storage

Detachable, pivoting  
wheel base for easy  
transport, upright support,  
and protection of  
segmented rollers

Segmented rollers  
exert pressure on  
uneven surfaces

Improved!  
Easy to  
transport

**Extendible  
Floor Roller**  
10-955

10-935  
10-950  
10-952  
10-955

All floorcoverings are only as good as the quality of the installation. One of the most important factors in successful glue-down applications is ensuring that adhesive is transferred to the floorcovering backing.

Roberts offers a range of heavy-duty Floor and Wall Rollers to meet the many needs of today's professional flooring installer. Our Rollers ensure maximum transfer of adhesive to the flooring material with precision-ground and balanced segmented rollers.

As the company that invented many flooring installation tools, meeting the needs of the professional installer is Roberts' mission. We asked, researched and acted on your needs and feedback. Roberts has just improved our two heaviest rollers (10-950 & 10-952) by adding detachable, pivoting legs with sealed-bearing wheels to simplify transporting the roller to the job site and to protect the precision-balanced rollers.

Ideal for use when installing linoleum, VCT, carpet, sheet vinyl, cork and other floorcoverings, Roberts heavy-duty rollers are the true professional's choice.

*Let the improved Roberts heavy-duty rollers take the load off your back.*

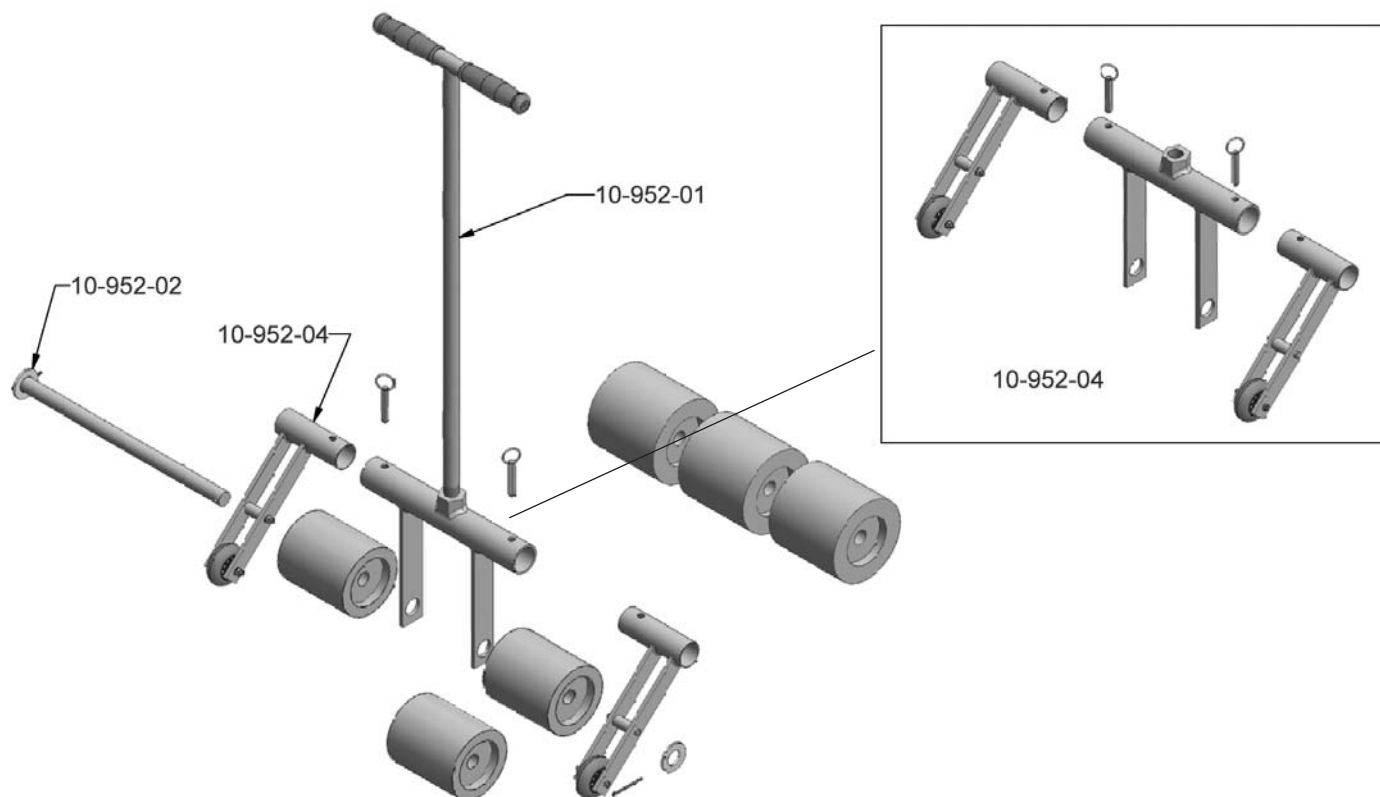

## Parts List

## 10-935, 10-950, 10-952

Part	Description	Qty.
10-952-01	Handle & Yoke Assembly (includes handle and central yoke)	1
10-952-02	Axle Assembly (includes axle, washer and cotton pin)	1
10-952-04	Linoleum Roller Upgrade Kit (includes central yoke, left and right kickstands and two pins)	1

These parts apply to the 10-935, 10-950 and 10-952.