



# Tile Leveling System 1/8" and 1/16" Leveling Clips

99710Q / 99715Q / 99718Q / 99721Q / 99756Q / 99757Q

Levels, aligns, spaces and holds large format tiles for an even installation

## CLIPS

2-part system (sold separately)

For Tiles up to 1/2" Thick

## WEDGES



**LEVEL**  
Flat base maximizes adhesive coverage and ensures tile surface is lippage-free

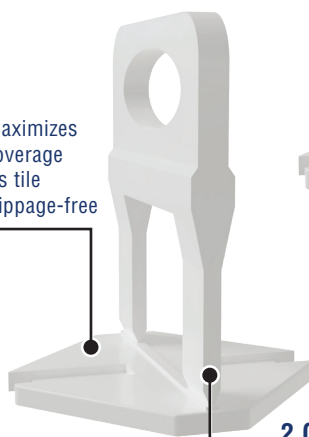

**2 CLIP SIZES**  
Spaces tiles 1/16" and can accommodate standard width spacers up to 1/4"

**TILE SIZE**  
Accommodates tiles up to 1/2" thick

**DESIGN**  
Notches on each side of the clip allow mortar to dispense evenly to eliminate potential voids

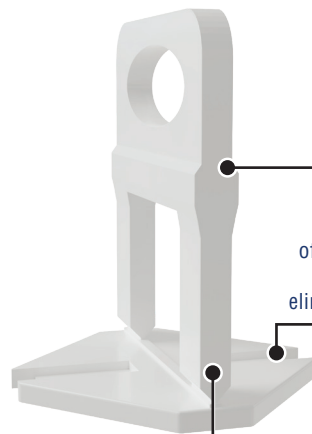

**2 CLIP SIZES**  
Spaces tiles 1/8" and can accommodate standard width spacers up to 1/4"



**HOLD**  
Wide wedge design holds tiles securely while mortar dries

**COST EFFECTIVE**  
Reusable 7/8" wide wedge

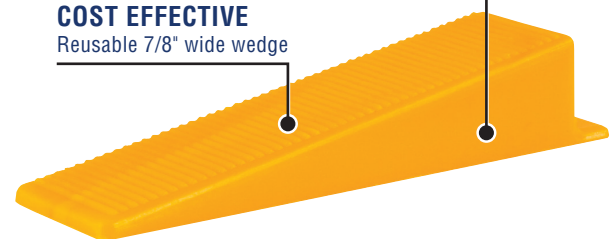

The Tile Leveling System was developed out of a need to diminish costly mistakes due to unlevelled tiles causing lippage in high-end installations. It is the perfect system to use with tile plank and large-format rectified porcelain, marble and stone and the flat base design is ideal for wall tile installations. This time saving system adjusts the height of the tiles and evenly holds their edges throughout the curing process. It is the most cost effective installation method on the market to eliminate lippage.

The Tile Leveling System comes in 2 clip sizes, 1/16" and 1/8", and provides narrow grout lines for tiles up to 1/2" thick. For grout joints up to 1/4", traditional spacers can be used.

The Brand that Stands for Excellence.

www.QEP.com

E0420-11569

## Easy to install and remove!



Slide two clips under the tile and into the mortar approximately 2" from each end of the tile. Place the second tile.



Slide the reusable wedges into the clips to level, align, space and hold the tiles.



Once mortar has set, simply tap the clips with a non-marring rubber mallet to snap off at the specially designated break-points. Save wedges for future use.

*The Wall & Floor Tile Leveling System should be used with a minimum 1/2" x 1/2" x 1/2" square trowel notch to apply the setting material. Back buttering your tile is always recommended.*

Item #	Type	Quantity
99710Q	<b>A</b> 1/16"	100/bag (8/case)
99756Q	<b>A</b> 1/16"	2000 Bulk Box (28 boxes/pallet)
99718Q	<b>A</b> 1/8"	100/bag (8/case)
99721Q	<b>A</b> 1/8"	1000 Bulk Box (50 boxes/pallet)
99715Q	<b>B</b> Wedges	100/bag (8/case)
99757Q	Pro Pliers	(6/case)

100 <b>A</b> + 100 <b>B</b>	
Tile Size	Coverage
16" x 16"	41 ft <sup>2</sup>
18" x 18"	56 ft <sup>2</sup>
24" x 24"	68 ft <sup>2</sup>

## 99757Q Pro Pliers

**ADJUSTABILITY**  
Easily adjusts for different wedge lengths

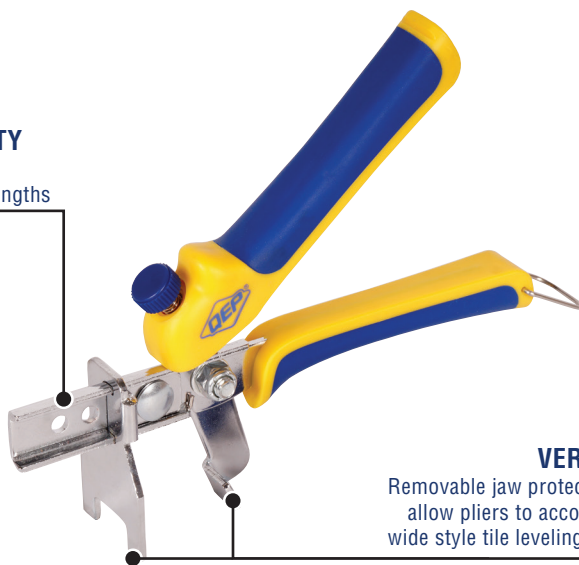

**VERSATILE**  
Removable jaw protective caps allow pliers to accommodate wide style tile leveling systems

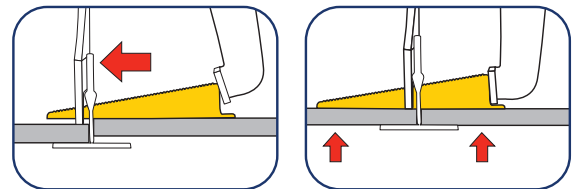

- Ensure wedges are set properly in the leveling clips every time (One to Two Clicks)
- Can also be used with the Original LASH Tile Leveling System and all similar Tile Leveling Systems

E0420-11569

The Brand that Stands for Excellence.

www.QEP.com